

HNE81FR

Indu-air downdraft induction hob

Installation, use and maintenance

Contents:

- 3 Important information
- 4 Important safety information
- 7 Important safety instructions
- 8 Safety warnings
- 11 Hob layout
- 12 Using your induction hob
- 12 Using the touch controls
- 12 Choosing the right cookware
- 14 Starting to cook
- 16 Locking the controls
- 17 Auto shutdown protection
- 18 Using the timer
- 19 Using the bridge zone
- 20 Heat settings
- 20 Care and maintenance
- 22 Installation
- 33 Mains electricity connection
- 35 Troubleshooting
- 40 Technical data

Important

The CDA Group Ltd cannot be held responsible for injuries or losses caused by incorrect use or installation of this product. Please note that CDA reserve the right to invalidate the guarantee supplied with this product following incorrect installation or misuse of the appliance or use in a commercial environment.

This appliance is not designed to be used by people (including children) with reduced physical, sensorial or mental capacity, or who lack experience or knowledge about it, unless they have had supervision or instructions on how to use the appliance by someone who is responsible for their safety.

Under no circumstances should any external covers be removed for servicing or maintenance except by suitably qualified personnel.

Appliance information:

Please enter the details on the appliance rating plate below for reference, to assist CDA Customer Care in the event of a fault with your appliance and to register your appliance for guarantee purposes.

Appliance Model	
Serial Number	

EU Declarations of Conformity

This appliance has been manufactured to the strictest standards and complies with all applicable legislation, including Electrical safety (LVD) 2014/35/EU and Electromagnetic interference compatibility

(EMC) 2014/30/EU. Parts intended to come into contact with food conform to 1935/2004/EC.

IMPORTANT INFORMATION FOR CORRECT DISPOSAL OF THE PRODUCT IN ACCORDANCE WITH EC DIRECTIVE 2012/19/EU.

At the end of its working life, the product must be taken to a special local authority waste collection centre or to a dealer providing appliance recycling services.

Disposing of a household appliance separately avoids possible negative consequences for the environment and health. It also enables the constituent materials to be recovered, saving both energy and resources. As a reminder of the need to dispose of household appliances separately, the product is marked with a crossed-out wheeled dustbin. 

Important safety information

- Under no circumstances should the extractor be connected to any gas ventilation system, flue system or hot air ducting system.
- Do not vent the extractor into an attic or loft space.
- Only house the extractor in rooms with adequate ventilation. Remember that the extractor is powerful and whatever air is extracted needs to be replaced.
- Do not tile the extractor in, it should be removable for service or maintenance.
- You must be able to isolate the extractor from the mains electrical supply after installation.
- Steam cleaners must not be used when cleaning this appliance.

- The performance of your extractor will vary depending on a number of factors including: type of extraction, length of ducting, room volume, ventilation available and cleanliness of the filters.
- Check and empty the water retainer regularly to avoid it overflowing.
- Never leave the appliance unattended when in use. Boil-over causes smoking and greasy spillovers may ignite.
- Never use your appliance as a work or storage surface.
- Never leave any objects or utensils on the appliance.
- Do not place or leave any magnetisable objects (e.g. credit cards, memory cards) or electronic devices (e.g. computers, MP3 players) near the appliance as they may be affected by its electromagnetic field.
- Never use your appliance for warming or heating the room.
- After use, always turn off the cooking zones and the hob as described in this manual (i.e. by using the touch controls).
- Do not rely on the pan detection feature to turn off the cooking zones when you remove the pans.
- Do not allow children to play with the appliance nor sit, stand or climb on it.
- Do not leave children alone or unattended in the area where the appliance is in use.
- Do not repair or replace any part of the appliance unless specifically recommended in the manual. All other servicing should be done by a qualified technician.
- Do not use a steam cleaner to clean your hob.
- Do not place or drop heavy objects on your hob.
- Do not stand on your hob.
- This appliance incorporates an earth connection for functional

- purposes only. Do not use pans with jagged edges or drag pans across the induction glass surface as this can scratch the glass.
- Do not use scourers or any other harsh abrasive cleaning agents to clean your hob as these can scratch the induction glass.
- This appliance is intended to be used in a household or similar environments such as staff kitchen areas in shops, offices and other residential environments.
- If the supply cord is damaged, it must be replaced by the manufacturer, its service agent or a similarly qualified person in order to avoid a hazard.
- Care should be taken to avoid touching the heating elements.
- Children less than 8 years of age should be kept away unless continuously supervised.
- This appliance can be used by children aged 8 and above and persons with reduced physical, sensory or mental capabilities or lack of experience and knowledge, if they have been given supervision or instructions concerning the use of the appliance in a safe way and understand the hazards involved.

WARNING: The appliance and its accessible parts become hot during use.

WARNING: Unattended cooking on the hob with fat or oil can be dangerous and may result in a fire. NEVER try to extinguish such fire with water! Switch off the appliance then cover the flame with a lid or a fire blanket.

WARNING: Do not store items on the cooking surfaces as this presents a fire hazard.

WARNING: If the surface is cracked, switch off the appliance to

avoid the possibility of an electric shock. The appliance is not intended to be operated by means of an external timer or separate remote-control system.

WARNING: In order to prevent movement of the appliance, it must be stabilised prior to installation. Please refer to the installation instructions.

WARNING: Only use hob guards that are either provided or deemed suitable by the manufacturer for use with this induction hob. The use of inappropriate guards can cause accidents.

WARNING: Danger of fire: do not store items on the cooking surfaces.

CAUTION: The cooking process has to be supervised. A short term cooking process has to be supervised continuously.



NOTICE: The crystallite glass is still hot after use, please do not touch!

Important instructions

Read these instructions carefully before installing or using this appliance.

- No combustible materials or products should be placed on this appliance at any time.
- Please make this information available to the person responsible for installing the appliance.
- In order to avoid a hazard, this appliance must be installed according to these instructions for installation.
- This appliance must be installed and earthed only by a suitably qualified person.

- This appliance should be connected to a circuit which incorporates an isolating switch, providing full disconnection from the power supply.

Failure to install the appliance correctly could invalidate any warranty or liability claims.

Safety warnings

Your safety is important to us. Please read this information before using the appliance.

Installation

Electrical Shock Hazard

- Disconnect the appliance from the mains electricity supply before carrying out any work or maintenance on it.
- Connection to a good earth wiring system is essential and mandatory.
- Alterations to the domestic wiring system must only be made by a qualified electrician.
- Failure to follow this advice may result in electrical shock or death.

Cut hazard

- Take care - panel edges are sharp.
- Failure to use caution could result in injury or cuts.

Operation and maintenance

Electrical shock hazard

- Do not cook on a broken or cracked hob. If the hob surface should break or crack, immediately switch off the appliance at the mains power supply (wall switch) and contact a qualified technician.
- Turn off the hob at the wall switch before cleaning or maintenance.
- Failure to follow this advice may result in electrical shock or death.

Health hazard

- This appliance complies with electromagnetic safety standards.
- However, persons with cardiac pacemakers or other electrical implants (such as insulin pumps) must consult with their doctor or implant manufacturer before using this appliance to make sure that their implants will not be affected by the electromagnetic field.
- Failure to follow this advice may result in death.

Hot surface hazard

- During use, the appliance becomes hot. Care should be taken to avoid touching the heating elements.
- Do not let your body, clothing or any item other than suitable cookware contact the induction glass until the surface is cool.
- Metallic objects such as knives, forks, spoons and lids should not be placed on the hob surface since they can get hot.
- Keep children away.
- Handles of saucepans may be hot to touch. Ensure that the saucepan handles do not overhang other cooking zones that are switched on. Make sure children can't reach the cookware handles.
- Failure to follow this advice could result in burns and scalds.

FOR THOSE WITH HEART PACEMAKERS OR ACTIVE IMPLANTS:

The function of this hob conforms to current electromagnetic interference standards and thus is in total compliance with legal requirements (2004/108/CE directives).

To avoid interference between your hob and a pacemaker, your pacemaker must be designed and programmed in compliance with the regulations that apply to it. As such, CDA guarantee only that our product is compliant.

With regard to the compliance of the pacemaker or any potential incompatibility, you should obtain information from the manufacturer or your attending physician.

Cooking on Induction

The principle of induction cooking is based on magnetic effect. When you put your cookware on an induction zone and switch it on, the electronic boards in the hob produce induced currents in the base of the cookware and instantly raise its temperature. This heat is then transferred to the food inside the cookware.

Hob layout

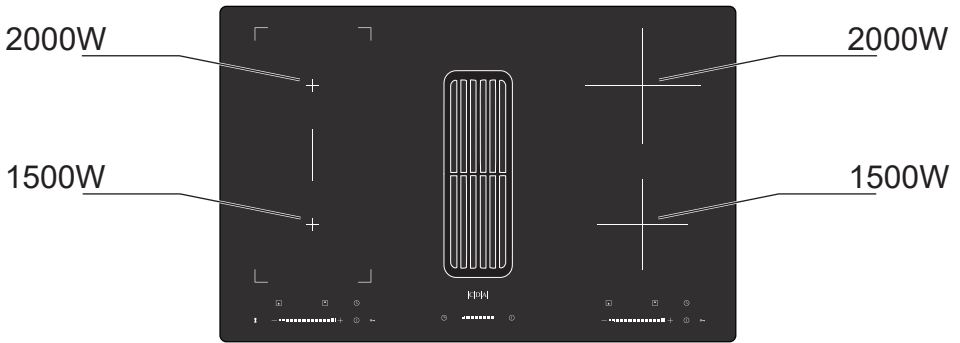

Induction hob

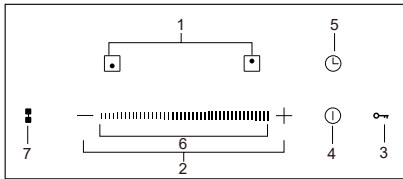

1. Heating zone selection controls
2. Power / Timer regulating key
3. Keylock control
4. ON/OFF control
5. Timer control
6. Slider controller
7. Bridge zone selection



Downdraft extractor

- 7-8. Extraction speed adjustment
9. Power ON/OFF
10. Delay

Using your induction hob

Before using your new hob

- Read this guide, taking special note of the ‘Safety Warnings’ section.
- Remove any protective film that may still be on your induction hob.

Using the touch controls

- The controls respond to touch so you don’t need to apply any pressure.
- Use the ball of your finger, not its tip.
- You will hear a beep each time a touch is registered.
- Make sure the controls are always clean, dry and that there are no objects (e.g. a utensil or a cloth) covering them.
- Even a thin layer of water may make the controls difficult to operate.

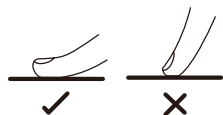

Choosing the right cookware

- Only use cookware with a base suitable for induction cooking. Look for the induction symbol on the packaging or on the bottom of the pan.
- You can check whether your cookware is suitable by carrying out a magnet test. Move a magnet towards the base of the pan. If it is attracted, the pan is suitable for induction.
- If you do not have a magnet:
 1. Put some water in the pan you want to check.
 2. If “” does not flash in the display and the water is heating, the pan is suitable.
- Cookware made from the following materials is not suitable: pure

stainless steel, aluminium or copper without a magnetic base, glass, wood, porcelain, ceramic and earthenware.

- Do not use cookware with jagged edges or a curved base.
- Make sure that the base of your pan is smooth, sits flat on the glass and is the same size as the cooking zone. Using a pot that is slightly wider means energy will be used at its maximum efficiency. If you use a smaller pot, efficiency could be less than expected. Pots with a diameter of less than 140 mm could be undetected by the hob if placed on the larger cooking zone. Always centre your pan on the cooking zone.
- Always lift pans off the induction hob – do not slide as they may scratch the glass.

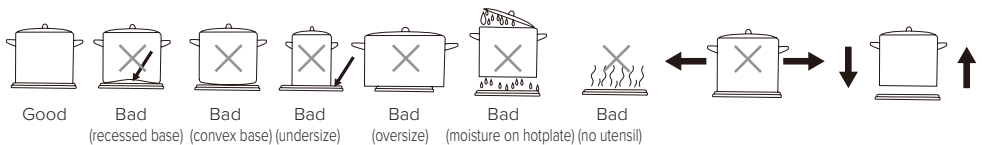

Saving energy

Using energy in a responsible way not only saves money but also helps the environment. The following will help you to save energy:

- Use proper pans for cooking. A saucepan should never be smaller than the zone. Always remember to cover any pans.
- Ensure pans and the hob are kept clean. Soils can prevent heat transfer and repeatedly burnt-on spillages can often only be removed by products which cause damage to the environment.
- Do not uncover the pan too often (a watched pot never boils!).

Be sure to recycle all of the packaging.

All packaging materials used are 100% recyclable.

Important

- Do not use the hob if the glass surface is cracked or damaged to prevent the risk of electric shock. Disconnect it from the power supply.
- Ensure that the power cable of a connected electrical appliance near the hob is not in contact with the cooking zones.

To start cooking

1. Touch the ON/OFF control.

With the power on, the buzzer beeps once, all displays show “ – “ or “ – – “, indicating that the induction hob has entered the standby mode.



2. Place a suitable pan on the cooking zone that you wish to use.

Make sure the bottom of the pan and the surface of the cooking zone are clean and dry.

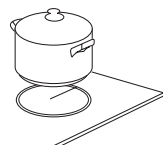

3. Touch the heating zone selection control and the indicator next to the key will flash.

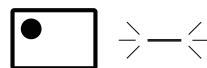

Select a heat setting by touching the “-“ or “+”

control. If you don't choose a heat setting within 1 minute, the induction hob will automatically switch off. You will need to start again at step 1.

You can touch the heating zone selection again and modify the heat setting at any time during cooking. If you don't choose a heat setting within 1 minute, the induction hob

will automatically switch off. You will need to start again at step 1. You can touch the heating zone selection again and modify the heat setting at any time during cooking.

Slider controller

Switch on the induction hob, press the optional key to select heating zone, the indicator next to the key will flash for 5 seconds, during this period, during this period, it's power can be adjusted from level 2 to 8 by the slider controller. Slide a scontroller from left to right, it is increase steps, slide from right to left to reduce steps.

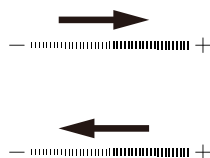

Slider controller can adjust power level only, it cannot adjust the timer function!

If the display flashes “” alternately with the heat setting, this means means that:

you have not placed a pan on the correct cooking zone or,

- The pan you're using is not suitable for induction cooking or,
- The pan is too small or not properly centred on the cooking zone.
- No heating takes place unless there is a suitable pan on the cooking zone.
- The display will automatically turn off after 1 minute if no suitable pan is placed on it.

When you have finished cooking

1. Touch the heating zone selection control that you wish to switch off.



1. Turn the cooking zone off by scrolling down to "0" . Make sure the display shows "0" and then "H".
2. Turn the hob off by touching the ON/OFF control.
3. Beware of hot surfaces indicator "H" will show which cooking zone is hot to touch. It will disappear when the surface has cooled down to a safe temperature. It can also be used as an energy saving function - if you want to heat further pans, use the hotplate that is still hot.



Locking the controls

- You can lock the controls to prevent unintended use (for example children accidentally turning the cooking zones on).
- When the controls are locked, all the controls except the ON/OFF control are disabled.

To lock the controls:

- Touch the lock key. The timer indicator will show "Lo".



To unlock the controls:

1. Make sure the induction hob is turned on.
2. Touch and hold the lock key for a while.
3. You can now start using your induction hob.

When the hob is in lock mode, all controls are disabled, except the ON/OFF. You can always turn the induction hob off with the ON/OFF control in an emergency, but you would have to unlock the hob first in the next operation.

Overheating protection

The appliance is equipped with a temperature sensor which can monitor the temperature inside the induction hob.

When an excessive temperature is monitored, the induction hob will stop operation automatically.

Detection of small articles

When an unsuitably sized or non-magnetic pan (e.g. aluminium), or some other small item (e.g. knife, fork, key) has been left on the hob, the display flashes “” and the hob will automatically go into standby mode in 1 minute. The fan will keep cooling down the induction hob for a further 2 minutes.

Auto shutdown protection

Auto shutdown is a safety protection function for your induction hob. It will automatically turn off after a certain period of time. The default working times for various power levels are shown in the below table:

Power level	1	2	3	4	5	6	7	8	9
Default working time (hour)	8	8	8	4	4	4	2	2	2

When a pot is removed, the induction hob can stop heating immediately and automatically switch off after 1 minute.



People with a heart pacemaker should consult their doctor before using this unit.

Using the timer

- You can set it to turn one cooking zone off after the set time is up.
- You can set the timer up to 99 minutes.

Setting the timer to turn off one cooking zone

1. Touch the heating zone selection control that you want to set the timer for.
2. Touch timer control, the minder indicator will start flashing and “30” will show in the timer display.
3. Set the time by touching the “+” and “-” buttons.
 - Hint: Touch the “-“ or “+” control of the timer once, time will decrease or increase by 1 minute.
 - Touch and hold the “-“ or “+” control of the timer, time will decrease or increase by 10 minutes.
4. Touch the “-” control to reduce the time outstanding to zero or press the “timer control” when “00” shows in the minute display to cancel the timer.
5. When the time is set, it will begin to count down immediately. The display will show the remaining time and the timer indicator will flash for 5 seconds.
6. When cooking timer expires, the corresponding cooking zone will switch off automatically.



NOTE: The red dot next to power level indicator will illuminate, indicating that zone is selected.

NOTE: Timer display will show the shortest set time of the selected zones. The cooking zone with the shortest set time will be indicated by a flashing red dot next to the power level.



Other cooking zones will keep operating if they have been turned on previously.

Using the bridge zone (maximum power 3000W)

To turn on the bridging zone:

1. Touch the bridge selection key to turn this zone on. The indicator to the right of the bridge zone selection key will be illuminated. The heat setting levels for the cooking zones within the bridge will default to “0” and can be set from a minimum of “1” to a maximum of “9”. Any previously set timers for these cooking areas will turn off and 2 dashes “--” will appear in the timer display.
2. Touch the Power level / Timer adjustment keys to change the setting. The selected heat setting will show in the heat level display for each cooking area within the bridge zone.



To turn off the bridging zone:

To turn the bridge zone off, touch the bridge zone selection key.

The bridge cooking areas will resume operation as 2 separate areas.

Cooking guidelines



Take care when frying as the oil and fat heat up very quickly. At extremely high temperatures oil and fat will ignite spontaneously and this presents a serious fire risk.

Heat settings

The settings below are guidelines only. The exact setting will depend on several factors, including your cookware and the amount you are cooking. Experiment with the induction hob to find the settings that best suit you.

Heat setting	Suitability
1-2	<ul style="list-style-type: none">• Delicate warming for small amounts of food• Melting chocolate, butter and foods that burn quickly• Gentle simmering• Slow warming
3-4	<ul style="list-style-type: none">• Reheating• Rapid simmering• Cooking rice
5-6	<ul style="list-style-type: none">• Pancakes
7-8	<ul style="list-style-type: none">• Cooking pasta
9	<ul style="list-style-type: none">• Stir-frying• Searing• Bringing soup to the boil• Boiling water

Care and maintenance

Always disconnect the appliance from the power supply before undertaking any cleaning or maintenance.

Everyday soiling on glass (fingerprints, marks, stains left by food or non-sugary spillovers on the glass)

1. Switch off the power to the hob.
2. Apply a hob cleaner while the glass is still warm (but not hot).
3. Rinse and wipe dry with a clean cloth or paper towel.
4. Switch the power to the hob back on.

When the power to the hob is switched off, there will be no hot surface indication but the cooking zones may still be hot! Take extreme care. Heavy-duty or some nylon scourers and harsh/abrasive cleaning agents may scratch the glass surface, so please do check that they are suitable for induction hob care before use. Never leave cleaning residue on the hob, the glass may become stained.

Boil-overs, melts and hot sugary spills on the glass

Remove these immediately with a palette knife or razor blade scraper suitable for induction hobs but beware of hot cooking zone surfaces:

1. Switch off the power to the hob via the isolation switch.
2. Hold the blade or utensil at a 30° angle and scrape the soiling or spill to a cool area of the hob.
3. Clean up the soiling or spill with a dish cloth or paper towel.
4. Follow steps 2 to 4 for everyday soiling on glass above.

Remove stains left by melts and sugary food or spillovers as soon as possible. If left to cool on the glass, they may be difficult to remove or even permanently damage the glass surface.

Spillovers on the touch controls

1. Switch off the power to the hob.
2. Soak up the spill.
3. Wipe the touch control area with a clean damp sponge or cloth.
4. Wipe the area completely dry with a paper towel.
5. Switch the power to the hob back on.

The hob may beep and turn itself off, and the touch controls may not function while there is liquid on them. Make sure you wipe the touch control area dry before turning the hob back on.

Installation information

Accessory list



Downdraft

1. ST4*10 screws
3. Connecting tube
4. Straight tube
5. Adaptor
2. Aluminium tape
6. Inlet grille
7. Grease filter
8. Extraction box
9. Water retainer
10. Motor
11. Adaptor

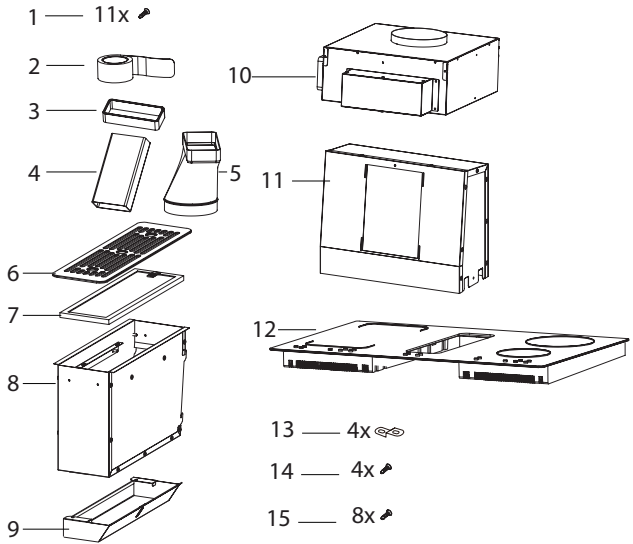

Induction Hob

12. Induction hob
13. Fixing brackets
14. ST4*13 Screws
(for junction box)
15. ST3.5*8 Screws
(for fixing brackets)

Overall installation size

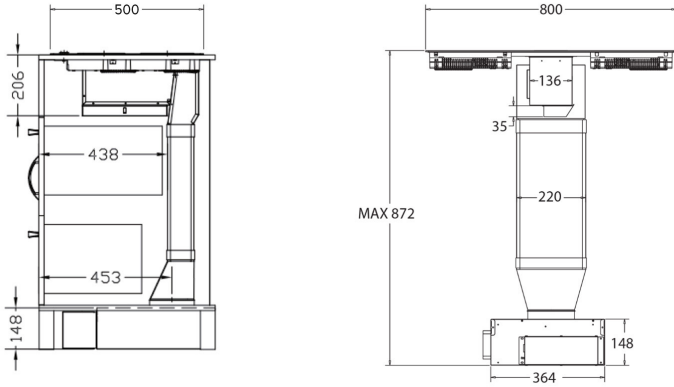

Induction hob installation

Cut out the work surface according to the sizes shown in the drawing. For the purpose of installation and use, a minimum of 5cm space should be preserved around the hole. Ensure the thickness of the work surface is at least 20mm. Please select a heat-resistant work surface material to avoid deformation caused by the heat radiation from the hotplate.

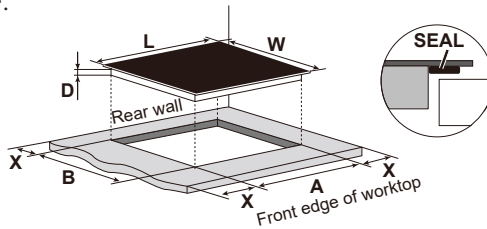

L (mm)	W (mm)	D (mm)	A (mm)	B (mm)	X (mm)
800	520	56	780	500	50 min

Make sure the induction hob is well ventilated and the air inlet and outlet are not blocked. Ensure the induction hob is in good working order.

Note: The distance between the hob and the cupboard above should be at least 600mm.

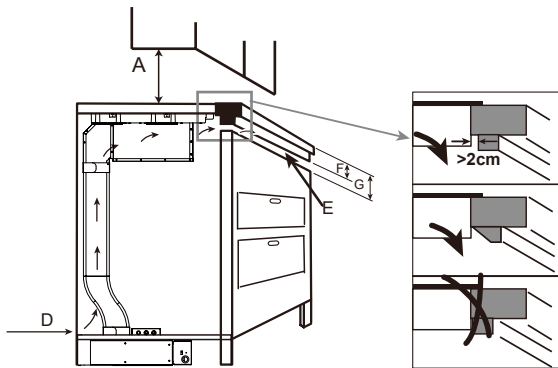

Note: There must be a 560x5mm opening in the front (position E) to dissipate the air.

A (mm)	D	E	F	G
600	Air intake	Air exit $\geq 5\text{mm}$	$>35\text{mm}$	$<50\text{mm}$



After installation, ensure the airflow opening is not blocked by the worktop.

Before you install the hob, make sure that:

- The work surface is square and level, and that no structural units interfere with the space requirements.
- The work surface is made of a heat-resistant material.
- The installation will comply with all clearance requirements and applicable standards and regulations.
- A suitable isolating switch providing full disconnection from the mains power supply is incorporated in the permanent wiring, mounted and positioned to comply with the local wiring rules and regulations.

- The isolating switch must be of an approved type and provide a 3mm air gap contact separation in all poles (or in all active [phase] conductors if the local wiring rules allow for this variation of the requirements).
- The isolating switch will be easily accessible after installation.
- You consult local building authorities and by-laws if in doubt regarding installation.
- You use heat-resistant materials (such as ceramic tiles) for the wall surfaces surrounding the hob.

Before locating the fixing brackets the unit should be placed on a stable, smooth surface to prevent damage. Secure the hob to the work surface using the brackets and screws provided

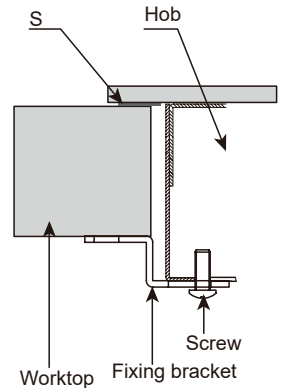

When you have installed the hob, make sure that:

- The power supply cable is not accessible through cupboard doors or drawers.
- There is adequate flow of fresh air from outside the cabinets to the base of the hob.
- If the hob is installed above a drawer or cupboard space, the temperature on the bottom of the hob may be too high. In order to prevent injury or risk of fire, a thermal protection barrier must be installed below the base of the hob.
- The isolating switch is easily accessible.

Caution!

- The induction hob must be installed by qualified personnel or technicians.
- The hob must not be installed directly above a dishwasher, fridge, freezer, washing machine or a dryer as the humidity may damage the hob electronics.
- The induction hob must be installed in a way that better heat radiation can be ensured to enhance its reliability.
- The wall and induced heating zone above the worksurface must withstand heat generated by the hob.
- To avoid any damage, the sandwich layer and adhesive must be resistant to heat.

Extractor installation

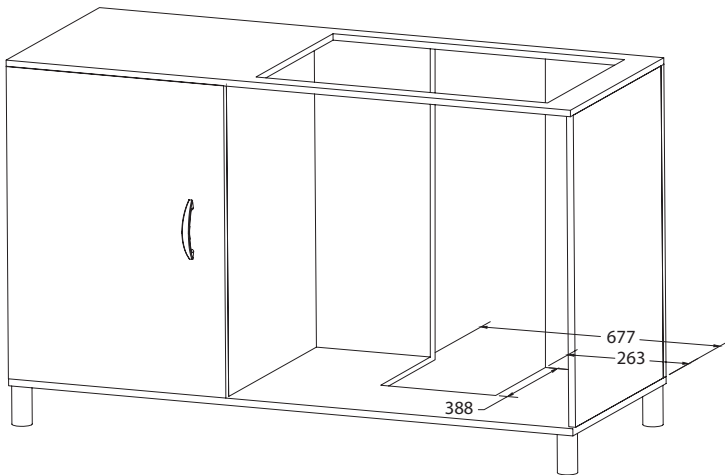

Fan system hole size

Installation of the adaptor and ducting channel

Align the four claws of the extraction box with the long holes of the adaptor. Lift the extraction box upwards to lock the claws in position and secure the box to the adaptor with a ST4 * 10 screw.

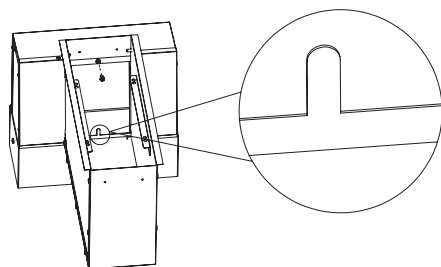

Carefully rotate the claw underneath the extraction box 180 degrees to ensure a tight fit to the adaptor.

Installation instructions for the air duct

Align the assembled extraction box, adaptor and ducting channel with the hob from inside the cabinet and secure in place with four ST4 * 10 screws.

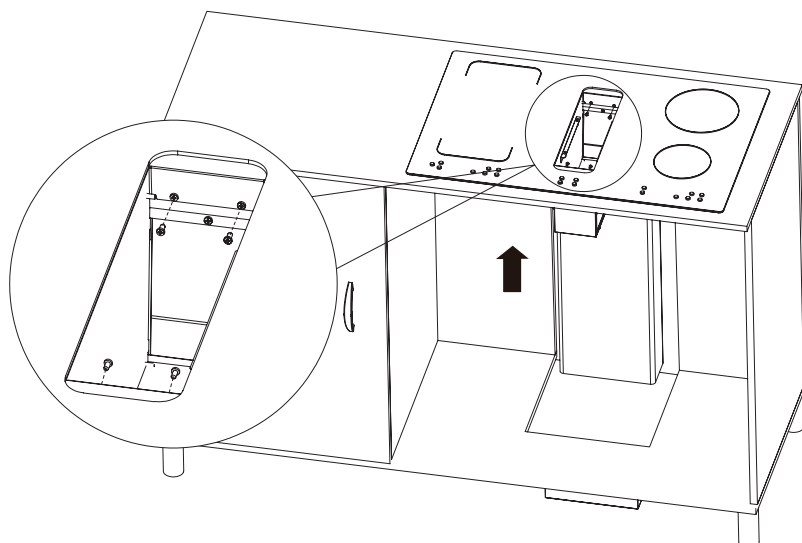

Connection tube installation

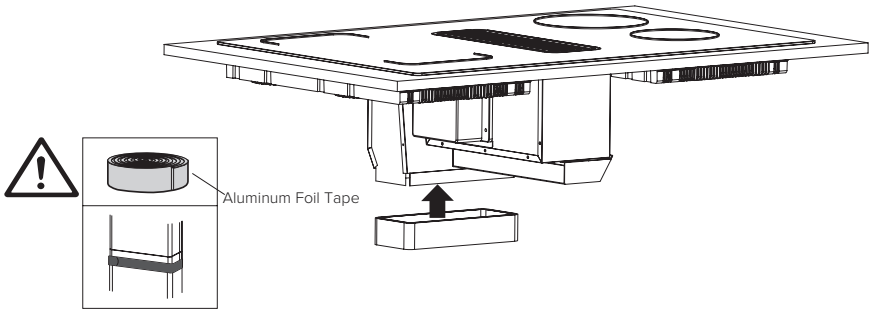

Adaptors and straight pipe installation

Match the adaptors and straight pipe to the round holes of the airbox and secure them using aluminum foil tape.

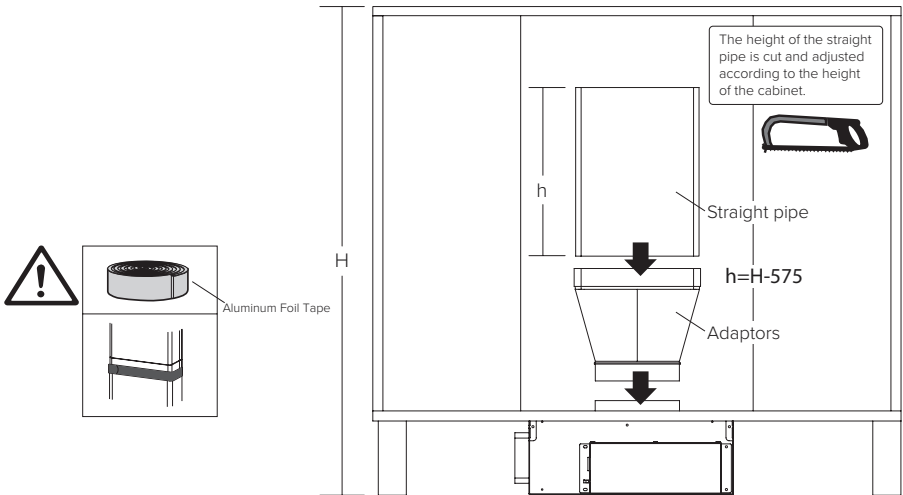

Stove installation

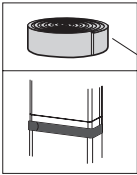
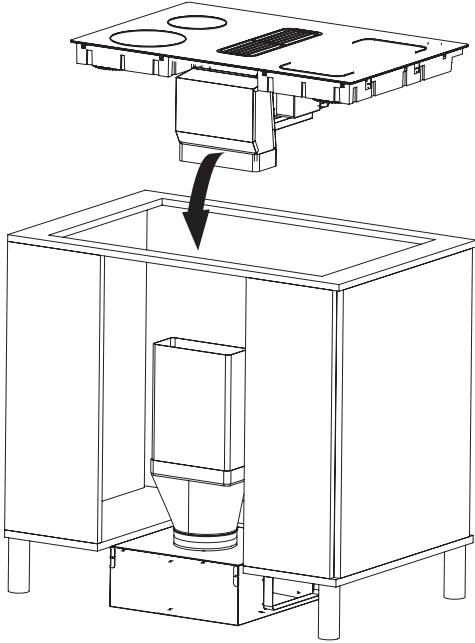

Aluminum Foil Tape

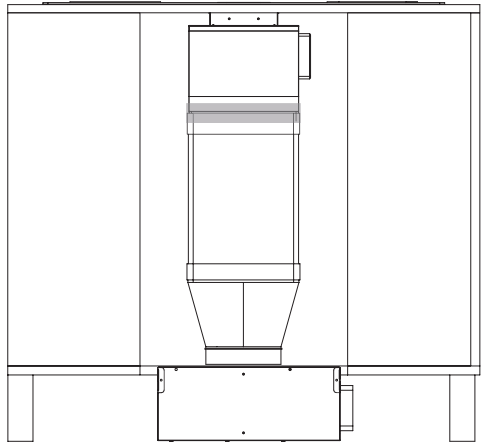
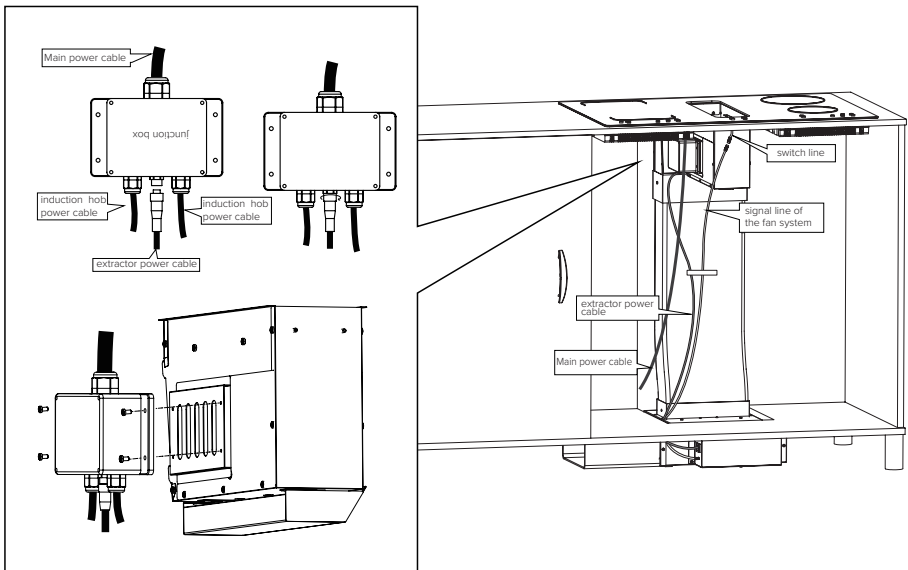

Fig.12

Wiring instructions

- Plug the extractor power supply into the corresponding junction box socket and tighten.
- Connect the power supply of the extractor.
- Connect the fan system signal line to the extractor switch on the underside of the induction hob.
- Once connected, fix the wires with a wiring harness (not included). Please note below illustration is schematic.
- Make sure the wiring is secure.
- Fix the junction box to the left side of the extraction box using ST4 * 13 screws in the accessory bag.



Cleaning the extractor grate

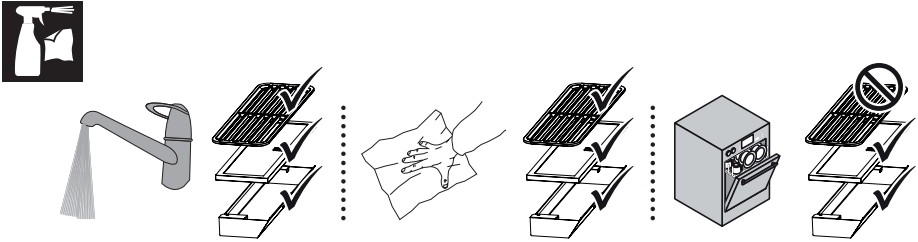

Grease filter and inlet grille installation

Position the charcoal filter as well as the grease filter on the brackets inside the extraction box and then cover the opening with the inlet grille. To ensure the best performance from your extractor, the charcoal filter should be replaced every 3-6 months, dependent on use.

Note: The charcoal filter is non-washable and must be replaced as required.

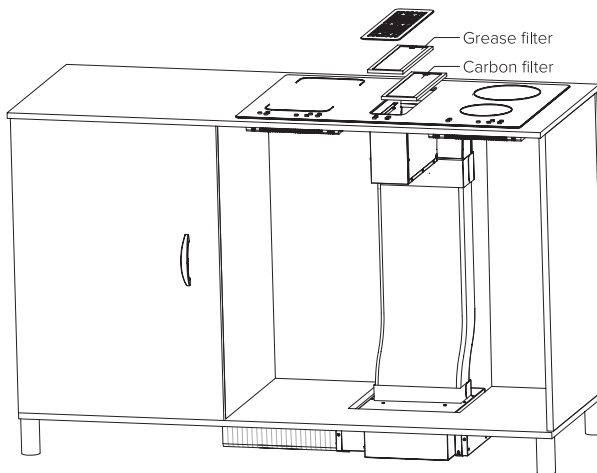

Water retainer installation

Insert the water retainer horizontally from the right hand side, ensure it is aligned with the extraction box and it is stable. The water retainer needs to be checked and emptied regularly.

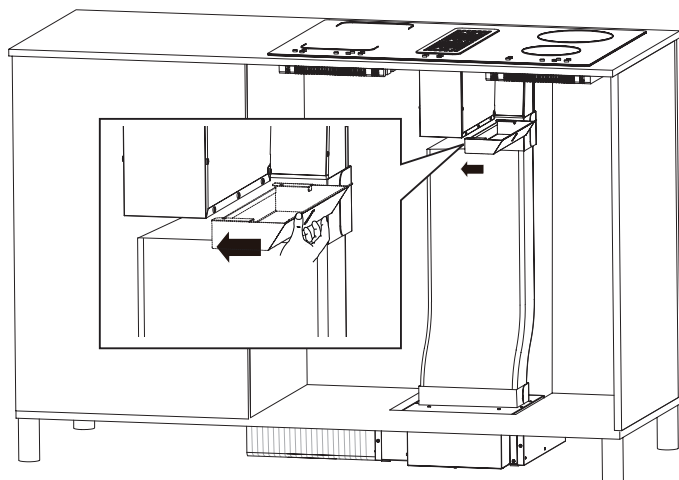

Finish installation

The method of connection is shown below, replace the cabinet drawer(s) or door(s).

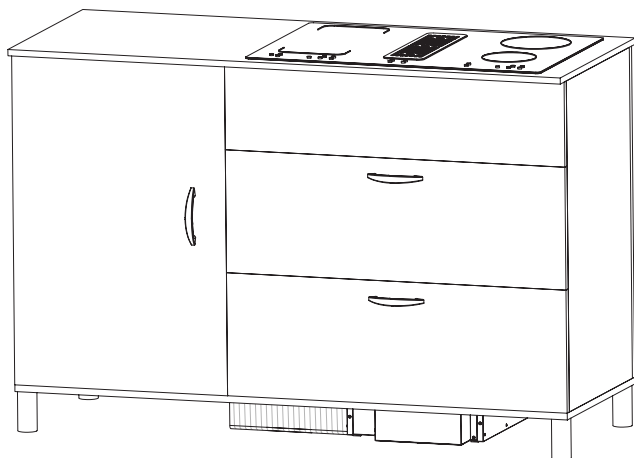



Mains electricity connection

Warning! This appliance must be earthed.

The appliance must be connected by qualified electrician, who is a member of the N.I.C.E.I.C. and who will comply with the I.E.T. and local regulations. When installing this product we recommend you seek the help of another individual.

Before connecting the downdraft induction hob to the mains power supply, check that:

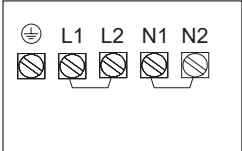
- The domestic wiring system is suitable for the power drawn by the downdraft induction hob.
- The voltage corresponds to the value given on the rating plate.
- The power supply cable sections can withstand the load specified on the rating plate.
- To connect the downdraft induction hob to the mains power supply, do not use adapters, reducers, or branching devices, as they can cause overheating and fire.
- The power supply cable must not touch any hot parts and must be positioned so that its temperature will not exceed 75°C at any point.
- Check with an electrician whether the domestic wiring system is suitable without alterations. Any alterations must only be made by a qualified electrician.
- The power supply should be connected in compliance with the relevant standard, or a single-pole circuit breaker. The method of connection is shown on page 34.

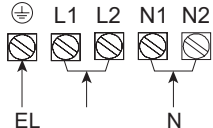
<p>Caution! Voltage of heating elements 220-240V</p> <p>Caution! In the event of any connection the safety wire must be connected to the  E terminal.</p>		<p>Recommended type of connection lead</p>
<p>For 220-240V earthed one-phase connection, bridges connect L1-L2 terminals and N1-N2 terminals, safety wire to </p>		<p>H07RN-F3G4mm²</p>

- If the cable is damaged or to be replaced, the operation must be carried out the by a service agent or a suitably qualified professional.
- The appliance for disconnection from the supply mains having a contact separation in all poles providing full disconnection under overvoltage category III conditions should be provided in fixed wiring in accordance with the wiring rules.
- The installer must ensure that the correct electrical connection has been made and that it is compliant with all applicable standards and safety regulations.
- The cable must not be bent or compressed.
- The cable must be checked regularly and replaced by authorised technicians only.

Troubleshooting

Induction hob troubleshooting

If an abnormality comes up, the induction hob will automatically enter the protective state and display corresponding protective codes

Problem	Possible causes	Possible remedy
The appliance does not work	Break in power supply	Check that power supply is turned on at the socket. If there is a neon light on the socket, check that this is illuminated. If the neon is not illuminated, check the consumer unit to see if the MCB or fuse has tripped. If there is a blown fuse, replace it with a new one. If the MCB has tripped, put it back in the "on" position. If the hob is of a wire connection type, disconnect the power, check if the wire is loose and if so, rectify. If the above checks have been carried out and the problem persists, a service is required.
During heating, the unit stops working	The timer has been set	If the timer has been activated to turn off a selected zone after a set period of time, once the time has passed, the zone will turn off. If you don't want the hob to turn off after a specific time, do not set the timer.
U	No pan or pan unsuitable	Ensure a compatible pan is being used. It must be suitable for induction cooking and not too small for the zone that is being used to ensure it is detected by the hob. If the problem persists, there may be a PCB synchronization or drive circuit fault, a service is required.
E2	Input power too low	Low voltage, voltage of the main power is less than 180V. Please check if the voltage of the main power is normal. Once the voltage has been normalised, re-start the unit. If the problem persists, a service is required.
E1	Input power too high	High voltage, voltage of the main power exceeds 250V. Please check if the voltage of the main power is normal. Once the voltage has been normalised, re-start the unit. If the problem persists, a service is required
F3	Thermistor of coil short circuit	Connection error of the sensor of coil thermistor or failure of the detection part of the PCB coil thermistor, a service is required
F4	Thermistor of coil open circuit	

Induction hob troubleshooting

Problem	Possible causes	Possible remedy
E5	Too high temperature of IGBT thermistor.	Too high temperature of the IGBT thermistor indicates that the air outlet may be blocked. Remove any obstructions and re-start the unit. If the problem persists, it is possible that the cooling fan has a connection error or has failed; or it may indicate a failure of the drive circuit of the fan, a service is required.
E3	Too high temperature of coil thermistor.	Too high temperature on induction glass surface, please check if the contents in the pan have been overcooked by accidentally cooking for too long. Turn cool down before turning it back on. If the problem persists, a service is required.
F9	IGBT thermistor short circuit	Connection error of the IGBT thermistor or failure of the detection part of IGBT PCB sensor, a service is required.
FA	IGBT thermistor open circuit	

In the event of a fault with the hob please advise CDA Customer Care.

Contact CDA Customer Care

A: Customer Care Department, The CDA Group Ltd, Harby Road,
Langar, Nottinghamshire, NG13 9HY

T: 01949 862 012

F: 01949 862 003

E: customer.care@cda.co.uk

W: www.cda.co.uk

Troubleshooting

Extractor troubleshooting

Problem	Possible causes	Possible remedy
The hood does not work	There is a power outage. Wire connectors are faulty or have disconnected.	Check power supply. Check orientation and security of connectors.
The output is low	Setting is insufficient for fumes present. Inadequate ventilation in kitchen. Charcoal filter (if fitted) is blocked. Exit ducting is obstructed. Exit flaps on motor housing are restricted	Try a more powerful speed setting. Ensure adequate air intake into kitchen. Replace charcoal filter. Remove any obstructions from ducting. Ensure flaps can move freely.
The hood stops mid operation	There is a power outage. The circuit breaker or fuse has tripped.	Check the power supply. Check circuit breaker or fuse.

Please do not disassemble the unit by yourself to avoid any danger or damage to the downdraft induction hob.

Hints and tips

1. If the induction hob cannot be turned on, make sure the induction hob is connected to the power supply and that it is switched on.

1. Check whether there is a power outage in your home or local area. If you've checked everything and the problem persists, call a qualified technician.
2. The touch controls are unresponsive.
The controls are locked: Unlock the controls. See section "Using Your Induction Hob" for instructions.
3. The touch controls are difficult to operate.
There may be a slight film of water over the controls or you may be using the tip of your finger when touching the controls: Make sure the touch control area is dry and use the ball of your finger when touching the controls.
4. The glass is being scratched.
Tough-edged cookware; unsuitable, abrasive scourer or cleaning products being used: Use cookware with flat and smooth bases. See "Choosing the Right Cookware" and "Care and Cleaning" for further advice.
5. Some pans make crackling or clicking noises.
This may be caused by the construction of your cookware (layers of different metals vibrating differently): This is normal, the noise should quieten down or disappear completely.
6. The induction hob makes a low humming noise when used on a high heat setting.
This is caused by the technology of induction cooking: This is normal, the noise should quieten down or disappear completely.
7. Fan noise coming from the induction hob.
A cooling fan built into your induction hob has come on to prevent the electronics from overheating. It may continue to run even after you've turned the induction hob off: This is normal and needs no

action. Do not switch the power to the induction hob off at the wall while the fan is running.

8. Pans do not become hot and “E” appears in the display.
The induction hob cannot detect the pan because it is not suitable for induction cooking. The induction hob cannot detect the pan because it is too small for the cooking zone or not properly centred on it: Use cookware suitable for induction cooking. See section “Choosing the Right Cookware”. Centre the pan and make sure that its base matches the size of the cooking zone.
9. The induction hob or a cooking zone has turned itself off unexpectedly, a tone sounds and an error code is displayed (typically alternating with one or two digits in the cooking timer display).
Technical fault: Please note down the error letters and numbers, switch the power to the induction hob off at the wall, and contact a qualified technician.

Technical data

Model	Power supply	Power				Size (mm)	Built-in hole size (mm)
		Heating area front left (180mm)	Heating area rear left (180mm)	Heating area rear right (180mm)	Heating area front right (180mm)		
HNE81FR	AC 220-240V 50Hz	1500W	2000W	2000W	1500W	800x520x62	780x500

The Manufacturer hereby declares that this product complies with the general requirements pursuant to the following European Directives and analogous UK requirements:

- The Low Voltage Directive 2014/35/EC / Electrical Equipment (Safety) Regulations 2016
- Electromagnetic Compatibility Directive 2014/30/EC / Electromagnetic Compatibility Regulations 2016
- ErP Directive 2009/125/EC / The Ecodesign for Energy-related Products Regulations 2010 (as amended) for the applicable implementing measures which apply in Great Britain and Northern Ireland, respectively

The product has been marked with **CE** and **UK CA** symbols and the Declaration of Conformity, the Manufacturer has drawn up the declaration and is available to the competent authorities regulating the market.



For service or queries relating to your product please contact:

The Customer Care Department on **01949 862 012** or email customer.care@cda.co.uk

For more information please contact:

The Sales Department on **01949 862 010** or email sales@cda.co.uk

Customer Care Department. The CDA Group Ltd, Harby Road, Langar, Nottinghamshire, NG13 9HY
T: 01949 862 012 **F:** 01949 862 003 **E:** customer.care@cda.co.uk